

Cotmoor Solar Farm

Note on Additional Planting at Manor Farm

PEGASUS REF: P18-2917

AUTHOR: Caroline Roe

DATE: 21st January 2021

Introduction

- 1.1 This Note has been prepared to provide details of planting which has recently taken place in the vicinity of the Application Site for the Cotmoor Solar Farm, land north of Halloughton (Ref: 20/01242/FULM), plus additional planting proposed to be undertaken in advance of works pursuant to the solar farm commencing.
- 1.2 The planting will impact on the visibility of the proposed development from public vantage points and is therefore relevant to the consideration of visual amenity effects undertaken in the Landscape & Visual Impact Assessment (LVIA) dated July 2020 and LVIA Addendum dated December 2020 and heritage effects considered in the Heritage Desk Based Assessment dated July 2020.

Planting Details

- 1.3 Attached at Appendix 1 is 'Manor Farm: Screening and Shelterbelt Planting Plan' which demonstrates the locations of the additional planting.
- 1.4 The planting relevant to the consideration of the solar farm is as follows:
 - Main new woodland planting adjacent to the southern edge of the Application Site of 14m width, plus a section of 10m width at its eastern extent
 - An additional strip of evergreen and copper beech trees adjacent to the south-eastern corner of the Application Site. Note that copper beech trees are planted to reflect this species in the village, including church yard.
 - A strip of planting adjacent to the south-west corner of the Application Site to be undertaken in advance of commencement of the solar farm development (subject to planning permission being granted).
- 1.5 Attached at Appendix 2 are photographs showing the planting in the locations identified above, undertaken in January 2021.

Visual Impact

- 1.6 As identified in the July 2020 LVIA and December 2020 LVIA Addendum, intervisibility between Halloughton, including the village conservation area, is limited due to existing intervening vegetation and proposed on-site planting. As confirmed in the

Pegasus Group

Birmingham | Bracknell | Bristol | Cambridge | Cirencester | East Midlands | Leeds | Liverpool | London | Manchester | Newcastle | Peterborough
DESIGN | **ENVIRONMENT** | **PLANNING** | **ECONOMICS** | **HERITAGE**

© Copyright Pegasus Planning Group Limited 2011. The contents of this document must not be copied or reproduced in whole or in part without the written consent of Pegasus Planning Group Limited

Heritage Desk Based Assessment dated July 2020, this would mean there would be only a very small degree of harm to the heritage significance of the conservation area and no harm to the significance of the Listed Buildings within the Conservation Area.

- 1.7 The identified planting which has been undertaken / will be undertaken in advance of works commencing will further limit any intervisibility.
- 1.8 The limited, and not unacceptable, effects in the conclusions of the LVIA and Addendum and the Heritage Desk Based Assessment are therefore further reduced by this planting which provides additional support for planning permission being granted.

Appendix 1:

'Manor Farm: Screening and Shelterbelt Planting Plan

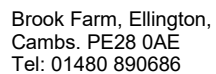

Manor Farm: Screening and Shelterbelt planting plan

SCALE : 1 : 7500 @ A4	DATE : 11/06/2020
--------------------------	----------------------



MAP FILENAME :
Manor Farm:New Planting

Map data shown may contain Ordnance Survey® products supplied by
Pear Technology Services Ltd; Email: info@peartechology.co.uk
© Crown Copyright and database rights from data shown above
Ordnance Survey® licence number 100023148

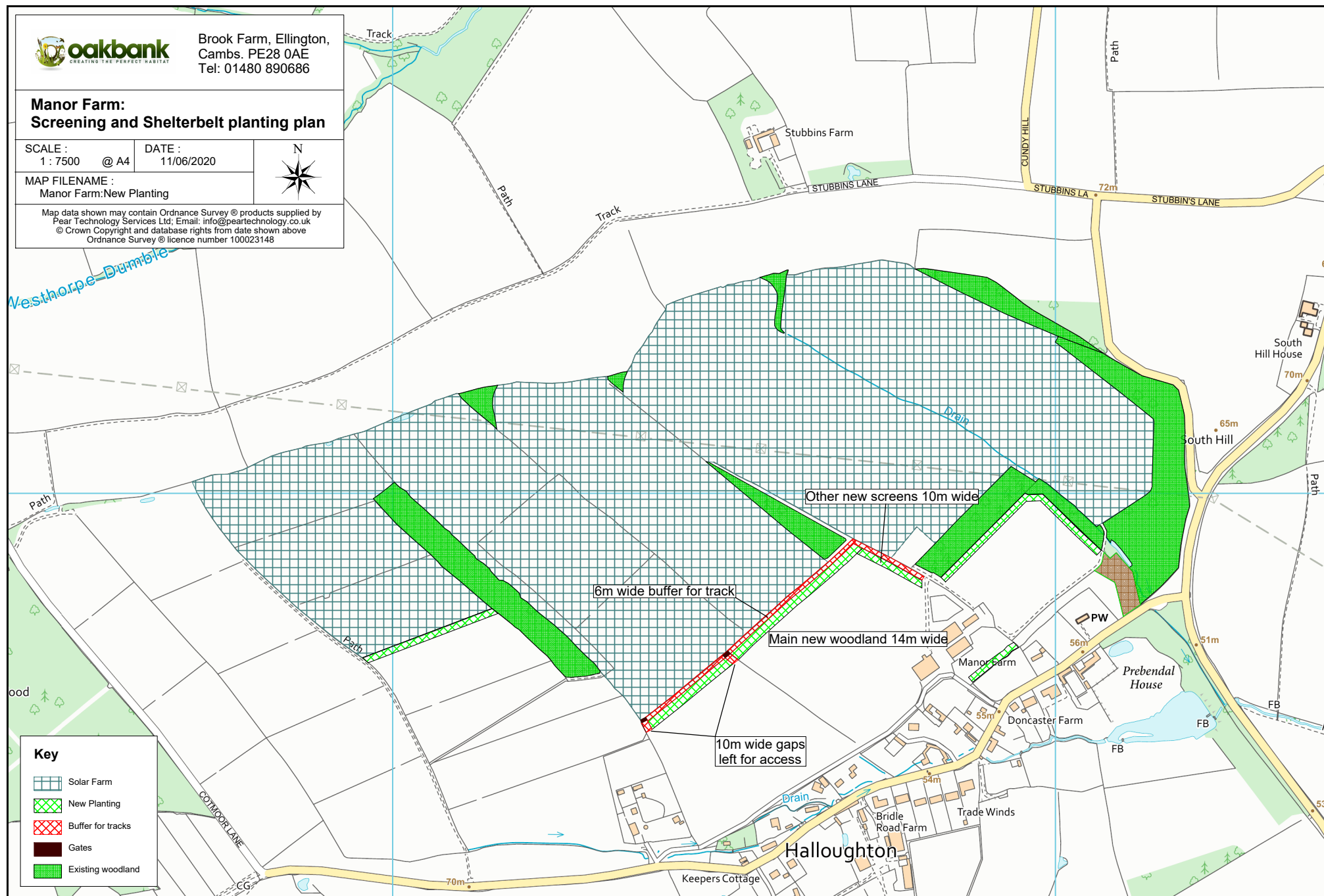

Appendix 2:

Planting Photographs









