

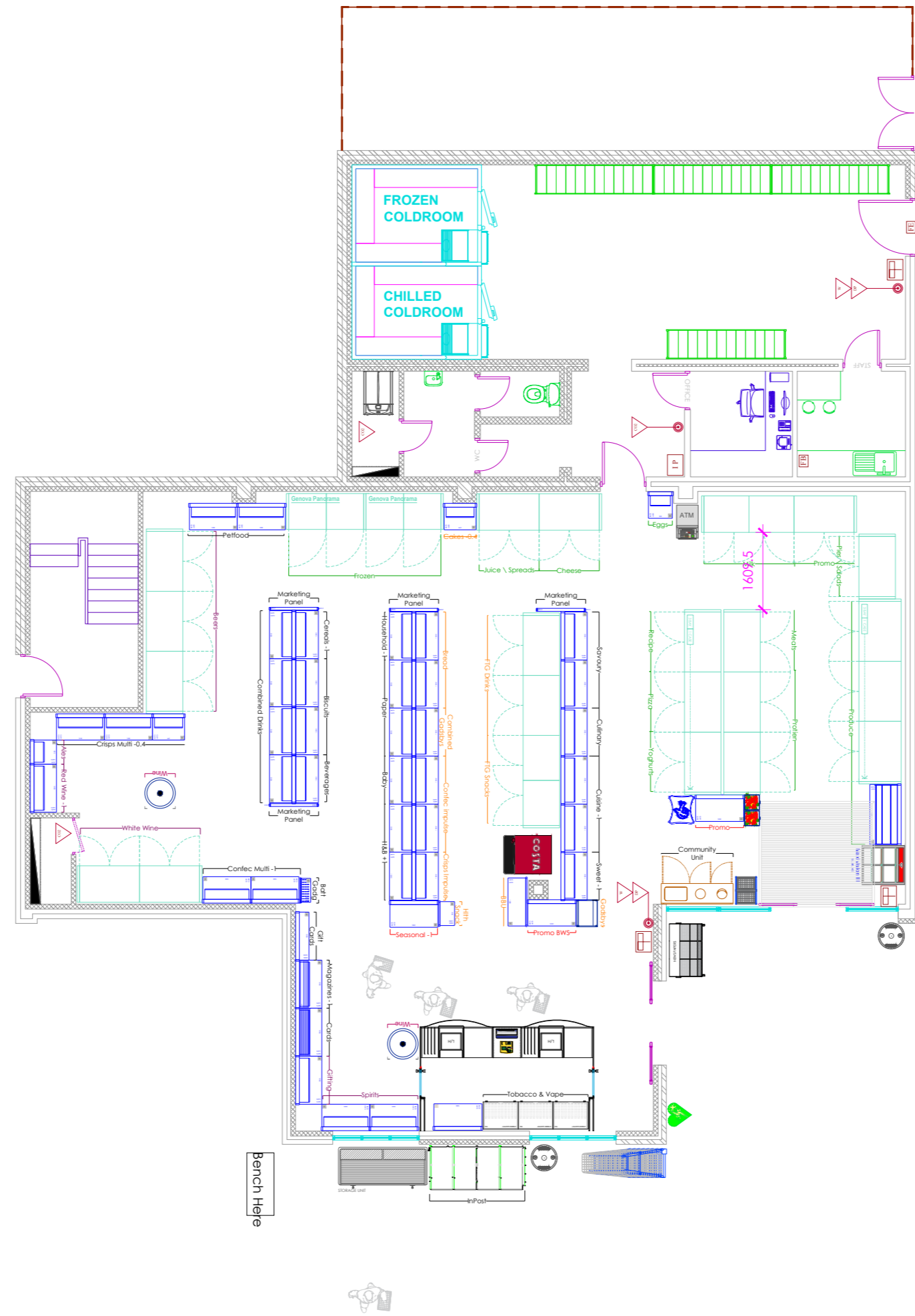

| | |
|---------------|-------------|
| SALES sqft | BOH sqft |
| 1925 | 806 |

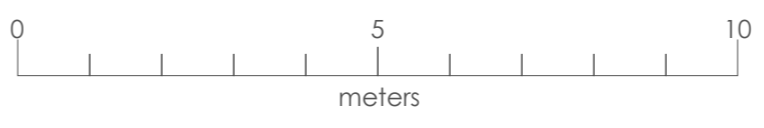

This drawing should be used for representation purposes only. DO NOT scale this drawing.



- Fire Blanket
- Fire Escape Door
- Portable Water Type Fire Extinguisher
- Portable Foam Type Fire Extinguisher
- Portable Dry Powder Type Fire Extinguisher
- Portable Carbon Dioxide Type Fire Extinguisher
- Fire Alarm Panel
- Fire Alarm Call Point, Manual (Break Glass)

Sutton on Trent
61 High St, Sutton on Trent, Newark NG23 6QA

| DRAWING NAME | | DRAWING NUMBER |
|---------------------------------------|--------------|----------------|
| 001082 Sutton on Trent [FD3402] [CR1] | | Current |
| DRAWING AUTHOR | LAST UPDATED | EDITED BY |
| NWOOD | 2025-02-04 | CHRIS.GLOVER |